

95 dodge neon manual transmission



File Name: 95 dodge neon manual transmission.pdf

Size: 3071 KB

Type: PDF, ePub, eBook

Category: Book

Uploaded: 24 May 2019, 23:51 PM

Rating: 4.6/5 from 599 votes.

Status: AVAILABLE

Last checked: 9 Minutes ago!

In order to read or download 95 dodge neon manual transmission ebook, you need to create a FREE account.

[**Download Now!**](#)

eBook includes PDF, ePub and Kindle version

[Register a free 1 month Trial Account.](#)

[Download as many books as you like \(Personal use\)](#)

[Cancel the membership at any time if not satisfied.](#)

[Join Over 80000 Happy Readers](#)

Book Descriptions:

We have made it easy for you to find a PDF Ebooks without any digging. And by having access to our ebooks online or by storing it on your computer, you have convenient answers with 95 dodge neon manual transmission . To get started finding 95 dodge neon manual transmission , you are right to find our website which has a comprehensive collection of manuals listed.

Our library is the biggest of these that have literally hundreds of thousands of different products represented.



Book Descriptions:

95 dodge neon manual transmission



See our stepbystep guide to replacing the clutch and the fivespeed manual transaxle used in the Caliber, Compass, and Patriot. The standard Neons came with a 3.55 ratio throughout the life of the car. The 3.94 ratio was used on performance models — with all DOHC engines, and then with 200104 Magnum engines. 199599 ACR models used the 3.94 ratio. As a result of the differing fifth gear ratios and axle ratios, the top gear ratio varied. Michael Volkmann wrote, “The second generation has added reinforcement ribs to the case to increase the ridigity of the unit and allow for larger loading; and the bell housing was changed increase case rigidity and allow for the hydraulic clutch actuation.” Oil capacity is 2.1 qt 2.0 L of a special fluid — not plain oil. Each of the separate crossover rail selection and select levers has pure rotary motion which minimizes shift effort. The driver cannot accidentally go into reverse from fifth due to a cam in the mechanism which moves the crossover lever into the threefour gate without binding or jamming. The paperfriction synchronizers are on the input shaft, lowering shift effort by cutting rotating inertia. A reverse brake mechanism minimized reverse engagement clash. There are needle roller bearing on all speed gears to reduce friction and extend gear life. The case has good bending stiffness, providing a natural frequency above the exciting frequency of the engine at peak RPM. The clutch cover is riveted to the flywheel, and the disc is captive inside the assembly. The hydraulically activated modular clutch is connected to the crankshaft through the same flexible drive plate used to attach the automatic transaxle torque converter. This eliminates the need for different crankshafts. The modular clutch is replaced as a unit; it is activated by a selfadjusting cable. The release lever is contained entirely within the bell housing, cutting the need for a flexible boot. Fifth gear was an overdrive gear to improve fuel economy. http://geoexcel.com/fckuploads/envi-4_2-manual.xml

- **95 dodge neon manual transmission, 95 dodge neon manual transmission fluid check, 95 dodge neon manual transmission reviews, 95 dodge neon manual transmission problems, 95 dodge neon manual transmission parts.**

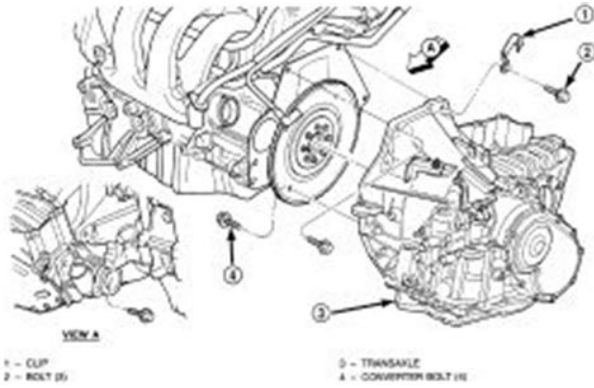

The fill plug was on the differential area of the rear case housing, and the drain plug was on the bottom of the bellhousing case half. On the transaxle's end cover was a metal identification tag. The rear of the transaxle was within the gear case housing; the backup lamp switch and vent were both near the top of the housing. The selector shaft moved up and down first to second, third to fourth, fifth to reverse, and the crossover shaft moved side to side between shift planes. A pin engaged the cam as the shifter came out of fifth, and the cam pushed the pin and shift assembly away from reverse. Also grease was not required on the retainer where the release bearing rode. The reverse idler gear was kept from clashing with the input and output shaft gears, and the input shaft was stopped before the idler gear engaged with another gear if a shift to reverse was attempted before the clutch spun down completely. The assembly consisted of a stop ring, friction cone, shim, needle bearing, and bearing race. It was not used on all NVT350 applications. Third to fourth and fifth to reverse were on the input shaft assembly, and first to second was on the output shaft assembly. The assemblies had a hub, sleeve, struts, springs, and detent balls. It was an opencenter design ring gear; it had a selectable shim on the outer race in the bellhousing case half which gave differential bearing preload adjustment. Adjustment for the side gear was made by changing the side gear thrust washers, which came in select thicknesses and various sizes. The input and output shaft bearings did not require any preload adjustment. They just need to have someone shift with the engine off while the other person watches the cables at the transaxle." The dealer usually replaces the entire cable assembly because the bushings are not sold separately by Chrysler." The aftermarket, though, does sell separate bushings. All rights

reserved. <http://turbobg.com/fckeditorfiles/envi-current-cost-manual.xml>



Dodge, Jeep, Chrysler, Ram, and Mopar are trademarks of Fiat Chrysler Automobiles. More Mopar Car and Truck News. Please help improve this article by adding citations to reliable sources. Unsourced material may be challenged and removed. It was available as a fourdoor notchback sedan and a twodoor notchback coupe. Available engines were SOHC and DOHC versions of Chryslers 2.0 L 4cylinder engine producing 132 hp 98 kW at 6,000 rpm and 129 lbft 175 Nm at 5,000 rpm or 150 hp 110 kW at 6,500 rpm and 133 lbft 180 Nm at 5,600 rpm, respectively; transaxle options were a

3speed Torqueflite automatic or a fivespeed manual.Certain color basemodel Neons, including red and black, had bumper covers molded in color rather than painted. These covers, while textured and not as glossy as paint, absorbed scuffs and scrapes with less visible damage. Initially, Neons were available in many bold colors including Nitro yellowgreen, Lapis Blue, Aqua, and Magenta, however paint color choices became more subdued by the 19981999 model years, as the majority of buyers opted for more traditional colors.Later, the LX model was replaced by the LE with the updated model in 1999.Please help improve this section by adding citations to reliable sources. Unsourced material may be challenged and removed. November 2011 Learn how and when to remove this template message Please improve it by verifying the claims made and adding inline citations. Statements consisting only of original research should be removed. November 2011 Learn how and when to remove this template message . The ACR offers no badging to distinguish it from other Neon models; the only visible differences are a bumper with fog light holes, but no fog lights and a lack of side moldings. For 1995, the ACR was only offered to SCCA members, but in subsequent years it was available to the general public.The second generation Neon was only available as a fourdoor sedan. In some global sales regions, including the U.S.

, the sole engine was the 2.0 L SOHC engine, the power output remaining at 132 hp 98 kW. An optional Magnum engine configuration with an active intake manifold, and other engine revisions to increase power that produced 150 hp 110 kW was available. Both engines had a redline of 6762 rpm.It was advertised that the second generation Neon had over 1,000 refinements from the original generation. The first generations frameless windows were replaced with a fullframed door. Other NVH refinements were implemented. The new interior and greater size increased weight. The DOHC engine Chrysler code name ECC was no longer available. The Neon was offered with a sport package for the 2001 model year only commemorating Dodges return to the NASCAR scene, called the Motorsports Edition. The last Plymouth Neon, which was also the last Plymouth ever produced a silver fourdoor sedan, rolled off the assembly line on June 28, 2001.However, this hurt gas mileage and made the car noisier on the highway, and eventually the original gear ratios were restored. A fourspeed automatic 41TE was offered in the Neon for the 2002 model year, and the 0305 received an updated 40TE fourspeed auto, replacing the earlier 3speed 31TH. In Australia and Canada, the Chrysler Neon was discontinued in 2002. The Chrysler Neon continued to be sold in Europe until 2004.Trim levels were 2.0 LX and 2.0 SE. However, some grey import versions came in from Mexico. The Japanese version was installed with leather interior, and was marketed as a small luxury car to Japanese consumers. In 2002, the Neon was replaced by the Chrysler PT Cruiser in Japan.Among these, the Neon performed the worst.Retrieved August 1, 2009. Retrieved May 15, 2015. By using this site, you agree to the Terms of Use and Privacy Policy. Something went wrong. View cart for details.User Agreement, Privacy, Cookies and AdChoice Norton Secured powered by Verisign. Something went wrong. View cart for details.

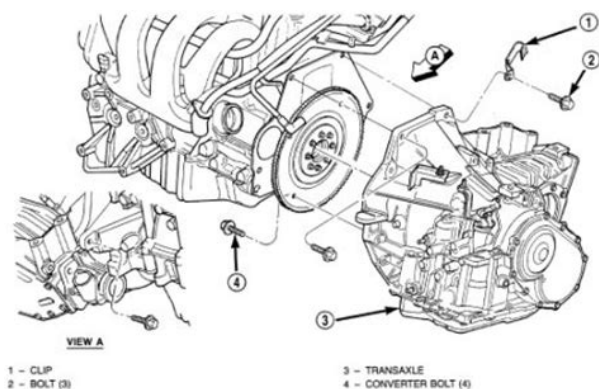

User Agreement, Privacy, Cookies and AdChoice Norton Secured powered by Verisign. Dodge Plymouth Click on make to find fitment. We use only the highest grade rubber and steel designed specifically for your application, and apply a finish that will not only enhance the appearance of the mount, but will also help to extend the life of the mount. Engine Sub Model Notes Fit Notes 2.0L L4 Base Insert Transmission Control Type Standard 2.0L L4 High Line Insert Transmission Control Type Standard 2.0L L4 Sport Insert Transmission Control Type Standard Also Fits Below Dodge Neon Years. 1999 1998 1997 1996 1995 This Part Also Fits Following Cars. Dodge Plymouth Click on make to find fitment. We use only the highest grade rubber and steel designed specifically for your application, and apply a finish that will not only enhance the appearance of the mount, but will also help to extend the life of the mount. Engine Sub Model Notes Fit Notes 2.0L L4 Base Complete Unit Transmission Control Type Standard 2.0L L4 High Line Complete Unit Transmission Control Type Standard 2.0L L4 Sport Complete Unit Transmission Control Type Standard Also Fits Below Dodge Neon Years. 1999 1998 1997 1996 1995 This Part Also Fits Following Cars. Dodge Plymouth Click on make to find fitment. Engine Sub Model Notes Fit Notes 2.0L L4 Base Complete Part Transmission Control Type Standard 2.0L L4 High Line Complete Part Transmission Control Type Standard 2.0L L4 Sport Complete Part Transmission Control Type Standard Also Fits Below Dodge Neon Years. 1999 1998 1997 1996 1995 This Part Also Fits Following Cars. Dodge Plymouth Click on make to find fitment. Please add to kart to see actual price. Please add to kart and checkout to avail special offer. Once the email has been received. To add a new vehicle, select the year, make, and model at left. Please try again. Please try again. Please try again later. A few bent fins or small dents and scratches do not affect the fit or the function of the part.

<http://www.gasparedicaro.com/images/canon-pixma-mx320-manual-guide.pdf>

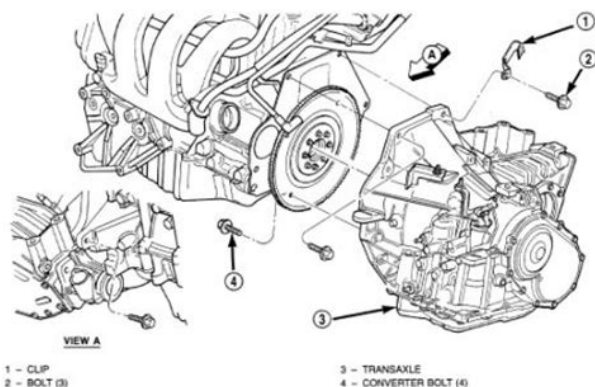

Neither our 60 Day satisfaction guarantee, nor the manufacturers warranty, cover these types of insignificant damages. In order to navigate out of this carousel please use your heading shortcut key to navigate to the next or previous heading. Please try your search again later. Makes a great replacement and has substantial cost savings over a dealer unit. Lifetime Warranty This item is backed by our limited lifetime warranty. In the event this item should fail due to manufacturing defects during intended use, we will replace the part free of charge. This warranty covers the cost of the part only. Transmission Cooler Note Some radiators are designed to be used on both automatic and manual transmission applications. These radiator may have fittings for an automatic transmission fluid cooler. However these radiators can be used on manual transmission models without issue and require no additional parts or modifications. Fits 199599 Dodge Neon with Air Conditioning 199599 Plymouth Neon with Air Conditioning To calculate the overall star rating and percentage breakdown by star, we don't use a simple average. Instead, our system considers things like how recent a review is and if the reviewer bought the item on Amazon. It also analyzes reviews to verify trustworthiness. Learn more opens in a new window or tab This amount is subject to change until you make payment. For additional information, see the Global Shipping Programme

terms and conditions opens in a new window or tab This amount is subject to change until you make payment. If you reside in an EU member state besides UK, import VAT on this purchase is not recoverable. For additional information, see the Global Shipping Programme terms and conditions opens in a new window or tab Delivery times may vary, especially during peak periods and will depend on when your payment clears opens in a new window or tab.

<http://www.amedar.com/images/canon-pixma-mx310-user-manual-download.pdf>



Learn More opens in a new window or tab Learn More opens in a new window or tab Learn More opens in a new window or tab Learn More opens in a new window or tab Please try again later. Contact the seller opens in a new window or tab and request a postage method to your location. Please enter a valid postcode. Please enter a number less than or equal to 1. Sellers may be required to accept returns for items that are not as described. Learn more about your rights as a buyer. opens in a new window or tab You're covered by the eBay Money Back Guarantee if you receive an item that is not as described in the listing. All Rights Reserved. User Agreement, Privacy, Cookies and AdChoice Norton Secured powered by Verisign. Neon 2005 Very possible the engine is bad, dont ask it is a long story. I dont want to The car is torn up and worn out. So, Please refer to CarGurus Terms of Use. Content will be removed if CarGurus becomes aware that it violates our policies. The Neon is a very reliable vehicle and is fun to drive. They say its a cheap piece of junk thats horribly unreliable. Thats exactly opposite the experience Ive had with mine. I bought my base model Neon for a pittance with low miles, in good working order. Nothing was power other than the steering. This is just fine by me, because seats are seats unless theyre unbearably stiff. The upshot of this model is that with regular maintenance it is incredibly rare to have major problems like in the Dead in less than 100k review. I maintain mine and I drive it like I stole it and I have never had a blown head gasket, a snapped timing belt, or any other major malfunction. It is, quite simply, BASIC but fun transportation. Keep your foot down and the worst mileage youll get is about 20mpg, but normal driving with maybe a little bit of fullthrottle, 30mpg is normal, give or take one or two.

All highway driving, Ive seen as high as 50 with a decent tail wind before I got back into city driving, but normal highway driving should net high 30s normally, 40 or a bit more if you go the full hypermiler route. The only real downside to the car is that until the last half of the first generation 9599, the paint quality was pretty bad, so once the cars got a few years under their belts the paint would get scraped and knocked off fairly easily and the car would rust out fairly quickly. Its fairly uncommon to find a pre97 or 98 Neon without at least one or two small rust spots. In my case rust will eventually make me scrap this one and swap all the major components over to a rustfree one. Basically a great cheap car with a lot of interchangeability and good allaround performance for what it is an economy car. Find a 97 or newer with a manual, have a trusted mechanic look it over, and

chances are you'll find it's a good deal even if it requires a little work. I bought my 95 Neon in 95 Highline 4DR Sedan, 5 Speed Manual Transmission, AC, power door locks. This car has been a relatively troublefree, economical, and enjoyable vehicle for the past 11 years. Styling Anybody who buys a specific car usually does so because the model has some initial appeal. The Neons quirky exterior appearance is high style to some, but just goofy to others especially from the front. I find it appealing. The interior layout is spacious. I'm of average height, and I have tremendous headroom in this car. Rear passengers are usually surprised by the room in the rear seat. When shopping for a used Neon 9598 look for oil leakage around the heads. Ask if head gasket was ever replaced with the new aluminum gasket. 6 Clutch burned out. Not really counting this one. Value This car was cheap to buy and it has been cheap to maintain. Fuel economy Last year I took a 1500 mile highway trip and averaged 37 MPG. It was winter, and the AC was off, and I have the manual transmission.

<http://www.ponderosafestival.com/wp-content/plugins/formcraft/file-upload/server/content/files/162802e0d899a2---Browning-gold-hunter-12-gauge-manual.pdf>

still outstanding for a 10 year old car. Overall If you want a luxury vehicle, or a car with terrific acceleration and handling, this isn't for you. Mechanics have worked on it and can't fix it. And it has just under 100K! I would never BUY one, but it was ok to zip around in for a few days. The thing that bugged me about it was the skimpy skeleton and slipshod interior. The doors felt as if they were made of cardboard glued together, with flattened tin cans for the exterior. Not sure how this rated in crash tests or reliability, but let's just say that riding in the back seat sure felt like having two pieces of paper between yourself and total oblivion. I am not an owner, so take what I say with a grain of salt, but I would approach this model with caution. You can surely do better. It is by far the best engine package, as the dual cammer puts out 18 more horsepower than Neon's 2.0 liter single overhead cam. Read More. Back to login Login here We do not store credit card details nor have access to your credit card information. If 30 days have gone by since your purchase, unfortunately we can't offer you a refund. To be eligible for a return, your item must be returned to us in the original packaging, with your original purchase information enclosed. To complete your return, we require a proof of your original purchase from us, please enclose a copy of your order confirmation email, invoice or your original order number when making a return. There are certain situations where no refunds are granted The injectors is damaged or missing parts for reasons not due to our error. Any item that is returned more than 30 days after delivery. As always our replacement warranty will apply to failures and defects that occur after the 30 day return period. We have been in the business of remanufacturing automotive fuel injectors for over 10 years. In this time we have become an industry leader in quality, affordability and dependability.

Each and every one of our fuel injector cores is put through a rigorous cleaning and testing process using ultrasonic cleaners and the ASNU Injector Diagnostic Testing and Servicing system before it is sold to our customers, ensuring the highest levels of reliability. If you want NextDay, we can save the other items for later. Order by, and we can deliver your NextDay items by. You won't get NextDay delivery on this order because your cart contains items that aren't "NextDay eligible". In your cart, save the other items for later in order to get NextDay delivery. Oops! There was a problem with saving your items for later. You can go to cart and save for later there. Get more info Ask a question Ask a question If you would like to share feedback with us about pricing, delivery or other customer service issues, please contact customer service directly. So if you find a current lower price from an online retailer on an identical, instock product, tell us and we'll match it. See more details at Online Price Match. Related Pages Radiator Fans Yitamotor Engine Parts Radiators Radiator Caps Automotive Radiator Additives TYC Radiators Dorman Automotive Replacement Parts and Accessories All Rights Reserved. To ensure we are able to help you as best we can, please include your reference number Feedback Thank you for signing up. You will receive an email shortly at Here at Walmart.com, we are committed to protecting your privacy. Your email address will never

be sold or distributed to a third party for any reason. If you need immediate assistance, please contact Customer Care. Thank you Your feedback helps us make Walmart shopping better for millions of customers. OK Thank you! Your feedback helps us make Walmart shopping better for millions of customers. Sorry. We're having technical issues, but we'll be back in a flash. Done.

<https://events.citeve.pt/chat-conversation/bose-wave-music-system-multi-cd-changer-manual>